

CHALFONT CHALLENGE 5K

Course Map(not to scale)

Chalfont, PA

PA12002LMB

Effective 5/10/2012 to 12/31/2022

START- On N. Main St, in front of Borough Hall, directly even with the S. edge of the single white traffic line that is across from the S. end of the Hall's N. window; 16' N. of the flag pole, 14' N. of telephone pole(TP) #195 on E. side of street; 20' S. of the sign pole for the Tofton Law Office; 73' S. of TP #205 on W. side.

1 MILE- On Lindenfield Parkway, between Sherri Dr & Megan Cir; 119' E. of the E. end of the sewer grate on S. side; 38' W. of the "SPEED LIMIT 25 sign pole & electrical box on S. side.

TURNAROUND- On N. Main St, just N. of Hellberg Ave, 46' N. of the N. edge of the sewer cover that is located in the N. end of the intersection of Hellberg; directly even with the mail box pole for house # 439; 51' S. of the fire hydrant on E. side.

2 MILE- On Rosemore Dr, at the intersection of Rosemore Cir, even with the E. end of the driveway for house #25; 12' W. of the W. end of the sewer cover located in the middle of the street; 17' E. of mail box pole #25; 37' E. of the E. end of the sewer grate on N. side.

3 MILE- On Sunset Ave, E. of the train station, at the W. end of building #15 at parking space #6; 38' W. of the W. end of the sewer cover located in the middle of the street.

FINISH- Same location as START.

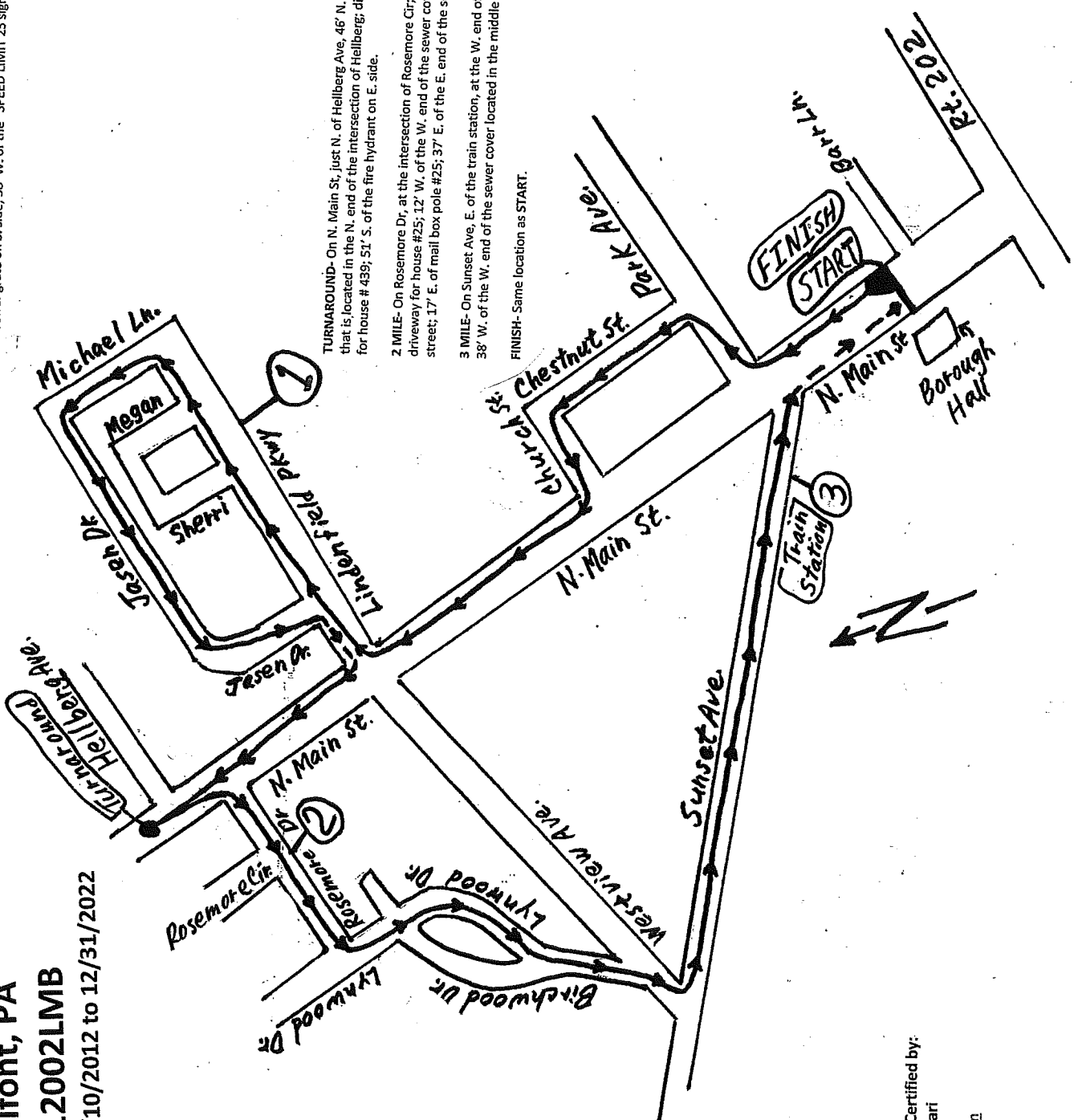

Measured & USATF Certified by:
 Larry M. Baldasari
 609-890-8343
 larsurf@aol.com
 5/10/2012